



**Barwon Valley Golf Club
50 Years**

A man wearing a white cap, a red and blue plaid shirt, and khaki overalls stands on a golf course. He is smiling and holding a golf club. The background shows a line of trees and a grassy area.

The year 2022 marks the 50th Anniversary of Barwon Valley Golf Club, originally Belmont Golf Club.

This book is dedicated to the men and women who, with foresight, commitment and hard work, sought to establish the club in its early years and contributed to its development and improvements throughout its 50 year history.

The Belmont Common and the Development of Barwon Valley Golf Club.

The traditional owners of the land upon which the golf course is situated is the Wadawurrung People. The area would have been abundant with eels, fish, birds, possums and various plants.

The Belmont Common refers to the large tract of land between Barwon Heads Road and the Barwon River in Belmont. The total area of the common was initially about 156 hectares before the Latrobe Tce and Breakwater rds major bridges and associated roads were constructed. After these major projects there remained 118 hectares. The Barwon Valley Golf Club occupies approximately 54 hectares of this area.

The Common has an interesting history. Pioneer aviator Charles Pratt, a New Zealander, leased the common in 1919 and established an aerodrome. Pratt and his brothers ran the business for many years.

In 1928, 10,000 Geelong residents turned up at the aerodrome to welcome famous Australian aviator Bert Hinkler who had just completed a 16-day England-Australia flight.

At the outbreak of the Second World War, the Government took over the aerodrome and Pratt's aircraft, and Pratt, went on to train Royal Australian Air Force pilots. The Common aerodrome remained until the early 1950s.



The Belmont Common, as it was in 1926. In the foreground is the Barwon Bridge and Geelong Lawn Tennis Club. Beyond that, the aerodrome which later became the site of the sporting ovals and site of the Barwon Valley Golf Club.

Image courtesy of Dave and Jenne Goldsmith, Geelong Aero Club from Kevin O'Reilly's book about Charles Pratt.

Timeline Belmont Common to Barwon Valley Golf Club

1839 – Governor Gibbs reserved the land known as Belmont Common- an open area of space.

1843- The Common came under the control of the district of Grant. The main purpose was the grazing of animals belonging to Geelong citizens.

1857- On May 4th the Common was gazetted as the South Barwon Municipal Common being Crown land vested in the Shire council.

1905- The Geelong Harbour Trust took over the management of the Common. It was still used for the grazing of animals.

1914 – Commenced being used as an airfield by the Geelong Aero and Gliding Club.

1920- The Geelong Harbour Trust funded the levelling of the Common to provide better for its use as an airfield. Famous aviators such as Sir Charles Kingford Smith, Amy Johnson, Bert Hinkler and Sydney De Kantsow (the founder of Cathay Pacific Airways) used the field at various times.

1940's -During World War 2, and for some years after, aircraft were stored and serviced at the Common and its use as an airfield continued.

1968 – Ceased use as an airfield.

1972- The Shire of South Barwon commenced construction of the Belmont Golf Club.

1972- holes 1 to 9 were opened in June of 1972. Operations commenced from a small shed and a small, relocated cottage was used as clubrooms.

Timeline cont.

1975 – Garbage tipping operations ceased at the southern end of the course and work commenced on the remaining 9 holes.

1972 – 1995 The course was managed by staff from the Shire of South Barwon.

1975 - About this time the driving range was established.

1978 -The course was extended to 18 holes.

1982 - Relocation of the Belmont Library building to serve as the clubrooms currently in use.

1985 – The name was changed from Belmont Golf Club to Barwon Valley Golf Club Inc.

1995 – BVGC took over partial management of the activities of the course.

1995- Major 50yr flood caused widespread, devastating damage to the course, clubhouse and driving range.

1996- The beginning of the 5 year battle with the Geelong Council and Kennett Government to save the Belmont Common from a planned international standard, water sports complex.

2000- The club took over full management and maintenance duties for the club.

2002 – In February of 2002 the Council resolved to renew the lease to the Barwon Valley Golf Club for a further 10yrs.

2006 - Major project of the drainage system from the Jerringot Wetlands to the Barwon River and the first dam completed.

Timeline cont.

2008- Completion of the \$250 000, 2 year project to become water self sufficient with the completion of 2 dams bounded by the 4th, 7th and 8th holes. The dams use filtered stormwater overflow from the Jerringot wetlands.

2011 – Reopening of 14th 15th and 16th holes following the redesign by Bob Shearer. The reconfiguration of the course became necessary because of the Breakwater Bridge re-alignment by Vicroads.

2015 - "Slice" a computer program for golf administration was implemented. Enabled online organization of competitions, scanning of score cards and collating of results.

2015 - Renewal of the lease agreement with the City of Greater Geelong for a further 20 years.

2016 - The original kiosk, repurposed as a pro-shop, was renovated and upgraded.

2019 - Planning commenced for refurbishment of the clubrooms - Planning grant from City of Greater Geelong.

2020 - Successful grant application for \$350 000 from the City of Greater Geelong towards the clubroom refurbishment.

2020 - 2021 - A series of lockdowns and restrictions due to the covid pandemic.

2020 - Governance shifted to a "One Club" committee model, as recommended by Golf Australia, which led to the discontinuation of the Women's Committee.

2020 -2021 - MyClub golf administration computer package adopted, in stages, by the club.

The Golf Club

In the beginning...

In 1970 the Shire of South Barwon commenced construction of the first nine holes of the course. As most of the area, except for margins along the river, was dedicated to airfield use, trees and shrubs were non-existent. The Shire commenced tree and shrub planting but it is understood, that from the earliest times, volunteers did much of the planting work.

This work was impeded by flooding, salty ground or drought conditions. Volunteers suffered the frustration of seeing plants and grasses die however they persevered with their efforts.

Around that time the southern section of the golf course was used as a tip site for the disposal of waste. This ranged from household garbage, industrial waste including old tyres, machinery parts, foul smelling waste from fish processing premises and everything in between.

The tipping of rubbish continued well into the mid 1970's but by 1978 the council had constructed the second or southern 9 holes. According to older members, their condition could best be described as "rugged".

Members from the very early days, report that play was usually restricted to about 6 months of the year due to either flooding or excessive surface water. In addition, care of the course by the shire was haphazard. On some occasions the greens were uncut for long periods making them almost unplayable.

Developmental difficulties

It should be appreciated that the Belmont Common is part of the Barwon River flood plain and was subject to regular inundation by floodwaters. Drainage systems were not adequate or efficient. The construction of dams on the Barwon and Moorabool rivers somewhat relieved the problem but not entirely as evidenced by the disastrous flood of 1995 and other occasions of significant flooding.

Belmont Golf Club 1972

Despite the efforts of the shire to encourage golfers to use the course, patronage was poor. In 1972 the Shire called a special meeting of interested persons to form a club in the hope that patronage would improve.

At that meeting Mr Gordon Russell was elected President, Mr Bill Perrett- Vice President and Publicity Officer and Mr Noel Edwards – Club Secretary.

Belmont Golf Club, the forerunner of Barwon Valley Golf Club, came into being.

In 1973 the club colors were set as emerald green and white!

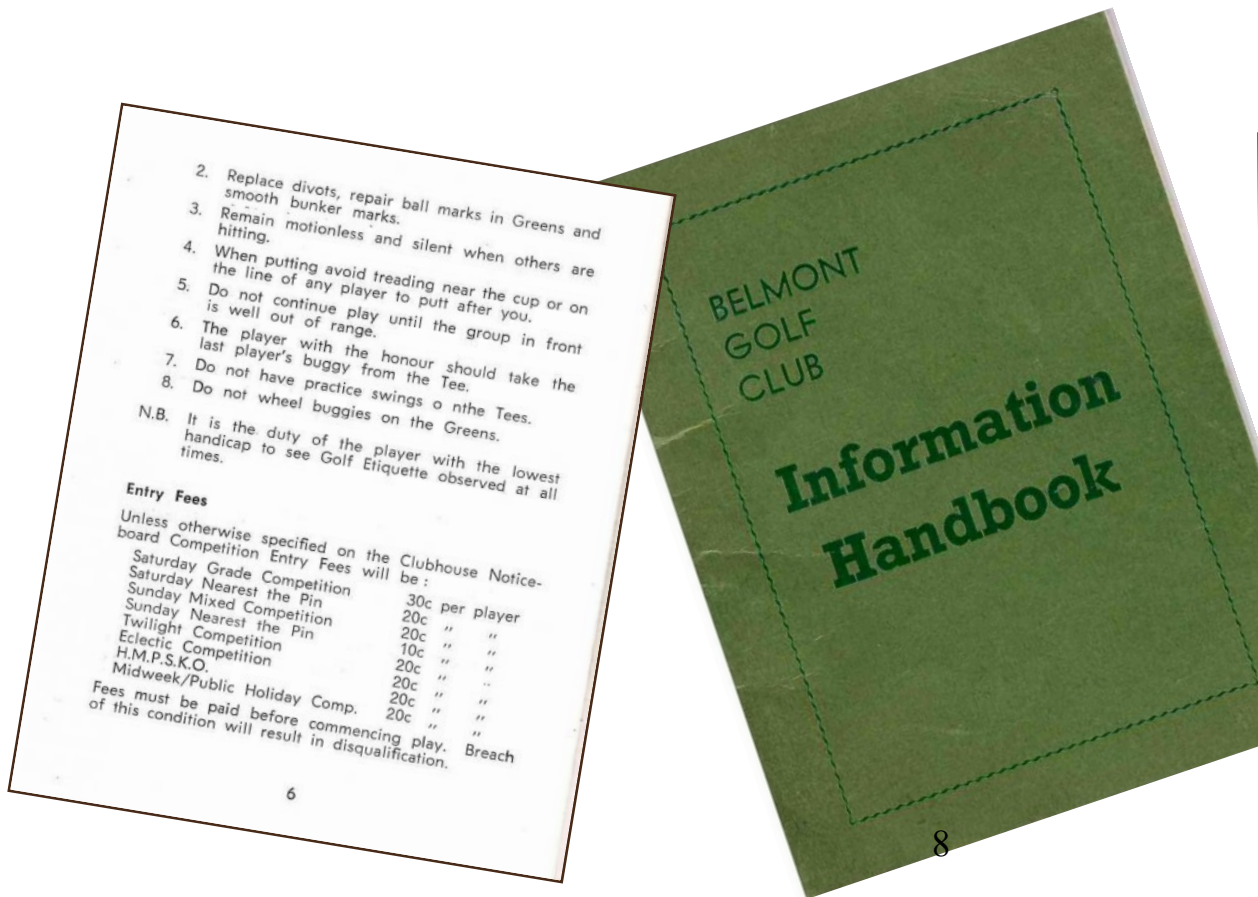

MEMBERSHIP OF THE CLUB

Types of Members
The Belmont Golf Club provides for Members, Associate Members, Junior Members and Social Members.

Joining Members
A prospective Member (including Associate, Junior and Social Members) must be Proposed and Seconded on the official Membership Application form by financial Members of the B.G.C. of at least 12 months standing. The Joining Fee (where applicable) must be paid with the Membership Application so that the Application may be considered at the monthly General Committee Meeting. If the Application is successful the new Member is notified and the balance of Fees become due. Note: Once the Membership Application and Joining Fee have been lodged with the Secretary the Prospective Member is eligible to play in Competition or to return cards for the gaining of a handicap.

It is the responsibility of the Proposer and Seconder to introduce the new Member to Club Officials and other Members, to advise the new Member of all rules governing the conduct of the B.G.C. and to ensure that the new Member can competently perform the duty of Marker of a fellow competitor.

Membership Fees (p.a.)

	Member	Associate Member	Social Member	Junior Member
Joining Fee	5.00	5.00	5.00	—
Annual Subscription	15.00	12.00	6.00	50%
Season Ticket	25.00	25.00	—	50%

4

The Clubrooms

At the time of the initial course construction, the Shire President, Eric Lyons arranged for a small residential cottage to be relocated from Thomson St Belmont, the current site of the Coles supermarket, to the Golf Course to serve as clubrooms. The toilet block was some distance from the clubrooms and, if there were a night time gathering, the ladies would be escorted to the toilet block by the light of a hurricane lamp.

In 1982, the shire offered the Belmont Library building to be used as clubrooms. It was a timber framed structure and was relocated to its present site. Much work was necessary to refurbish it, involving many working bees, of which Harold (Tab) Adams, a builder, was the coordinator. The building was virtually a barn when first relocated. It appears that toilet facilities did not exist in the building at the time but were added in an extension later.

The Early Years of the Club

There have been many wonderful people, both men and women, who have contributed to the development of the club since its inception in 1972 to the current day. Some of these people were bestowed with Life Membership due to their outstanding and dedicated service.

It's apparent that those recipients of the award either played significant roles at critical times during the club's history, served very long terms on the Executive Committee, General Committee or Women's sub committee or were very active members of the volunteer work force for many years.

The Barwon Valley Golf Club has bestowed the coveted LIFE MEMBER AWARD to fourteen recipients over the past 50 years.

The contribution of each of these recipients will be recognised in the following pages.

Bill Perrett

Bill Perrett (Life Member) was born in Geelong in 1927. Bill's initial appointment was as the Publicity Officer and Vice President for Belmont Golf Club. He took over the Presidency reigns in 1972. He performed these duties until 1981.

He led the Club through its formative years taking a pivotal role in lobbying for inclusion into the Geelong District Golf Association. Along with Neil Huggins (Secretary), Graeme Bath (Captain), and the committee of the day he spent many hours in negotiations with the Local Council and others, pressuring for the extension of the course to 18 holes. This occurred in 1978.

The Barwon Valley Golf Club acknowledged Bill's large contribution by naming him as its first Life Member.

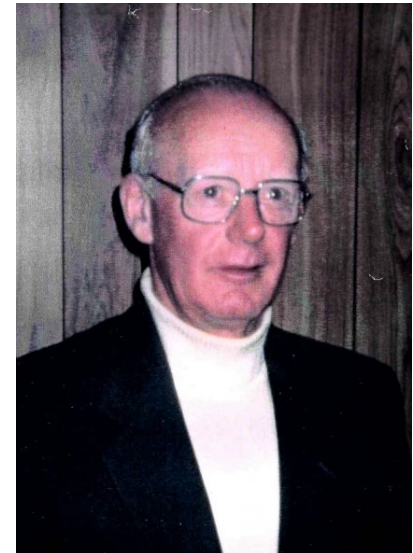

The early years cont.

Bill said that, although the shire was keen to encourage usage of the course, it was reluctant to carry out good maintenance. On some occasions the greens were left uncut for so long that putting, with any degree of success, was just about impossible. He also recalled playing the first 9 holes when garbage tipping was still in progress to the south, with participants finding it difficult to tolerate the nauseating smell.

Bill recalled the quite primitive conditions under which early members played and in particular the regular flooding of the course. One incident he recounted (with fear in hindsight) was taking a rowing boat, with his son, through flood waters to turn off the electricity and feeling the power surges, when in the water, at the meter box.

Neil Huggins



Neil Huggins (Life Member) was one of the founding members of the Belmont Golf Club (actually member no.2). He went on to serve 10 years as Secretary of the club from 1973 to 1983, an extraordinary contribution to its early success during difficult times. He took on the role of President from 1984 to 1986. From about 1983 to 1995 he co-ordinated the running of the course by volunteers.

Neil recalled the lack of co-operation from the council and the never-ending working bees to upgrade the clubrooms, rectify flood damage, plant trees and undertake the many tasks confronting the club during the formative years.

Neil was born in Geelong in 1926. At age 17 he joined the Royal Australia Navy and served on a destroyer in the Pacific theatre of WW11. After the armistice his ship was involved in picking up Japanese prisoners of war. After the war Neil worked in several notable Geelong businesses: International Harvester, State Electricity Commission, Geelong Cement Company and then Pilkington Glass where he rose to the position of Personnel Manager.

"The Associates"

In the early years of the club women were able to join as associate members. In 1973 a Ladies Committee was formed with elected officials.

"Associates shall have the power to elect their own officers and arrange all affairs relating to their section of the club, but in so far as their own affairs, in any way, effect members either indirectly or directly the Associate Committee shall seek and be bound by instructions from the General Committee"
(Article of Association of the Belmont Golf Club 1977)

The Associates became almost a club within a club and were self sufficient - even donating money to the general club for their share of electricity costs. They also contributed to the overall club through participation in working bees, catering, serving on sub-committees and the general committee.

As with most golf clubs of the time women were not permitted to play golf on a Saturday. A rule which persisted well past the time when many women worked full time and the only time available to play was on weekends.

By 1977 women were playing Saturday golf at BV though initially it was only nine holes. The lady who was on canteen duty would arrive about 9am, make rounds of sandwiches, put on pies, sausage rolls and hotdogs to heat up and then go out and play nine holes. After the ladies presentation it was back on duty, usually until at least 6pm as there was always plenty of the men in the club rooms for their presentation and they had to be gone before the ladies could clean up.

The Associates played a significant role in the move to the new club house (1982) and many of the lady members were involved in brightening it up, putting in many hours, helping with cleaning, painting, making of curtains, tablecloths etc.

Joan Nolan

Joan Nolan (Life Member) greatly contributed to the life of the club after joining in 1985. Virtually from day one, the golf club became a second home for Joan, who never married, but found great satisfaction in being involved in many club activities. She would serve behind the bar, prepare lunch for the “Golden Oldies”, co-ordinate Friday night chicken runs together with anything else that she believed needed to be done.



Joan was Ladies Captain from 1985-1988. Very early after her arrival at the club Joan also became the Ladies Handicapper, a role she held until 2006. She also held a position on the General Committee and was Tournament Secretary for a number of years.

Joan has been described as a "feisty" little lady who was a stickler for adherence to proper procedures, protocols, rules and ethical behaviour.



Brenda Hurst

The ladies also helped to establish the fairways. Brenda Hurst (Life Member) recalls that the ladies would carry two sand buckets with grass runners in them, which they planted, as they went round the course.

Around 2001 there was a move to integrate the men’s and women’s golf and Brenda was instrumental in trying to ensure that the recognition of the Ladies committee was maintained through this process.

Brenda, along with Margaret Perrett organised the Barwon Valley Ladies Inaugural Bowl which runs to this day.

Over the course of her time years at the “Club” Brenda spent approximately 16 years at Committee level, in various roles: Secretary of the ladies golf from 1983-1989 & 1997-2001, several years on the general committee and Ladies President 2012-2014

A Time of Growth

With the new clubrooms, an energetic committee and hardworking volunteers, the course was beginning to take shape.

Under the presidency of Neil Huggins the club became incorporated in 1985. The area of Belmont Common had been renamed Barwon Valley and the decision was made to change the club's name to Barwon Valley Golf Club Inc.

Frank Wilton

Frank Wilton (Life Member) joined the golf club around the time of his retirement in 1985. Frank was appointed club Secretary in 1986 and remained in the role until 1995, an extraordinary contribution to the club during some testing times. For some time thereafter, Frank served on the committee, and offered his guiding advice on many matters.

As a result of Frank's stewardship throughout those years, together with the efforts of several astute treasurers, the club had significant capital reserves to fund the very costly fight to save the Belmont Common and to ensure the future of the Barwon Valley Golf Club.

Frank was born in 1920 at St Arnaud. Prior to joining the army in 1939 Frank was apprenticed to a local butcher. Post war he established a butchery business with two of his brothers. A significant injury to his arm and shoulder after being gored by a bull, when he was buying cattle for his business, would later cause some restriction to his golf swing.

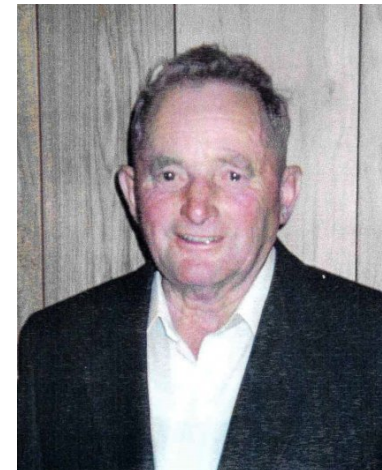

Major Threat

During the period around 1993 there was a State Government decision to amalgamate regional councils and their Municipal districts. The cities of Geelong, Geelong West, Newtown and the Shires of South Barwon, Corio and Bellarine joined to form the City of Greater Geelong.

Soon after, the Council of the new municipality, proposed to construct an Olympic Standard Rowing Course, referred to as the “Water Sports Complex” through Belmont Common, connecting with the Barwon River, from just south of the Barwon Bridge, for a distance of over 2.150km further south, beyond Breakwater rd.

The sport of rowing has always had a strong history in Geelong and district. The proposal had very strong support, particularly from the rowing fraternity, private schools such as Geelong Grammar, Geelong College and some similar Melbourne based schools. The Victorian Liberal Government of the time, under the leadership of Jeff Kennett, also supported the project.

Such a huge waterway would have overtaken, not only the whole of the golf course, but football and cricket grounds (and a baseball ground at that time), to both the north and the south of the course, including the dog obedience club, the Pistol Club and other passive recreation areas to the south of Breakwater Road.

At a meeting of golf club members, Councillor Anthony Aitken, then a member of the City Council, addressed the meeting, strongly suggesting that the construction of the water sports complex would proceed regardless of any objection users of the common might raise.

The council with its new found strong powers, was determined to proceed with the project.

Belmont Common belongs to all

The proposed waterway was to be 140m wide, with 4.5m embankments and emergency roads on each side for its full length, making an overall width of over 200 metres.

City rushing vote on water complex

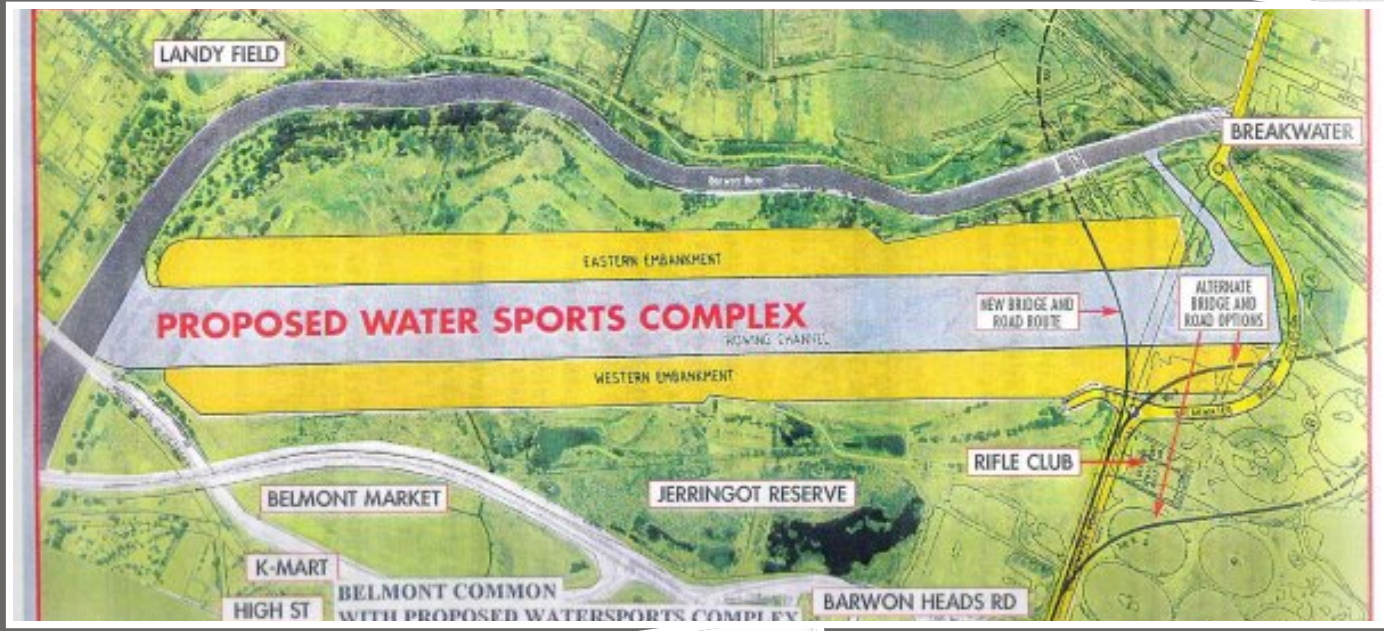

Watersports fight not over

Don't tamper with Mother Nature
THE citizens of Geelong must de

Wildlife haven on the common

The battle begins...

Although a number of those user groups, and other interested organizations were opposed to the project, it was the Golf Club that led the fight against it and funded most of the substantial costs involved.

Club members, led by Life Member Leon McNamara, convened public meetings to advise the Geelong community of the council's intentions to "steal" their public space in a most undemocratic way.

The battle commenced in early 1996 and raged for almost 5 years.



Leon McNamara

Leon McNamara (Life Member) joined the Barwon Valley Golf Club in 1991. When he became aware of the council's plan for the water sports complex he became outraged and determined to mount a challenge.

Through his experience with Apex organizations and additional experience in Union affairs, he was ably equipped to rise to the challenge.

With support from other user groups of the common eg the Geelong Field Naturalists Club and other interested bodies, he was instrumental in forming an organization known as "Friends of the Belmont Common".

Leon became the "face" representing the many objectors to the Council's proposal. He was perceived as the enemy by those having a vested interest in the project proceeding and was subjected to criticism both personally and in the media.



During those turbulent years, Leon experienced periods of ill health, which many close to him believed were aggravated by the stress under which he was placed.

The battle continues...

John Long

Alongside Leon in this battle was John Long (Life Member). At the time the council launched its proposal for the Water Sports Complex John was not then a member of the golf club. As a concerned citizen he had written to Mr Alistair Patterson MP to express his view that the proposal amounted to the stealing of public land for the benefit of few and to the disadvantage of many other user groups.

John was a friend and neighbour of Leon McNamara. They spent many hours together, over the 5 years, conducting “councils of war” to form a battle plan. John's experience in engineering and building surveying gave him the necessary skills to draft reports and letters to various authorities and organizations. He also made recommendations for the engagement of consultants, capable of finding the flaws, of which there were many, in the poorly prepared water-sports proposal. He believes this work, undertaken by The Friends of Belmont Common, hardened public opposition to the project.

When the Kennett Liberal Government was defeated at the 2000 elections, the City of Greater Geelong lost its major funding source and abandoned the project.

Thereafter the golf club members were given a new lease of life and renewed optimism for the future of the club.



During this time John joined the club and served on the General Committee.

John's background in construction, engineering , building law and regulation and his work with local councils as a building inspector aptly placed him to give technical advice to the committee in presenting their case.

John was also instrumental in the decision to pursue plans to provide dams and drainage to the course.

The Friends of Belmont Common and Latham's Snipe

The Snipe was chosen as the logo of the Barwon Valley Golf Club in recognition of the support from the Geelong Field Naturalists Club.

The Snipe is a bird which travels 9000 km from Japan, where it breeds, to South Eastern Australia. The Jerringot Wetlands, alongside the golf course, is considered one of the most important and ideal sites for the Latham Snipe. The birds arrive here about mid September and return to Japan about mid March.

Of international significance and listed under the JAMBA (Japan -Australia Migratory Birds Agreement), it became the symbol of the Friends of the Belmont Common and added weight in their fight to save the area for the various recreational user groups and to preserve Jerringot Wetlands as a natural habitat for a number of waterbird species recorded at this site.



THIS BIRD COULD SAVE YOUR GOLF COURSE

Some years later, around 2011, when the logo was changed, many members were opposed to instituting a new logo and considered that the change did not respect the legacy of those who had fought to save the club.

Management of the Club

In the early years the office was managed by council staff with the support of casual staff and volunteers.

January 1st 1995 the club took over partial management of the course from the council. Committee member, Barry Wasley, took on the role of office manager on a part time basis. This role became full time and was formalized in a contract in 1997 following an offer from the Council to extend the management agreement with the club until October 1999. Thereafter management rights were to be extended on a monthly basis determinable at the option of the council. Hardly surprising that there was little confidence for the club to invest in course development and upgrades with such uncertainty and amid the threat of the proposed Watersports Complex.

However, with the abandonment of the watersports project, the club entered discussions with the City of Greater Geelong to take over full management of the course and driving range. A huge decision for the committee of the day and not without risk. In 2000 the club was granted a 2 year lease.

Subsequent agreements to extend the lease gave the committee the confidence to invest in the future of the club. A period of relative autonomy and growth ensued.

Club Managers

1995 - 1998	Barry Wasley
1999-2000	Clinton Dupe
2000-2018	Robert McFarlane
2018- Sept 2020	Ben Casanelia
2020 - April 2021	Steve Power (moved to newly created position of Assistant Manager in 2021)
2021 - (current)	Nathan Sharrock, previously in a volunteer role as Club Treasurer, was appointed to the position of General Manager in April of 2021.

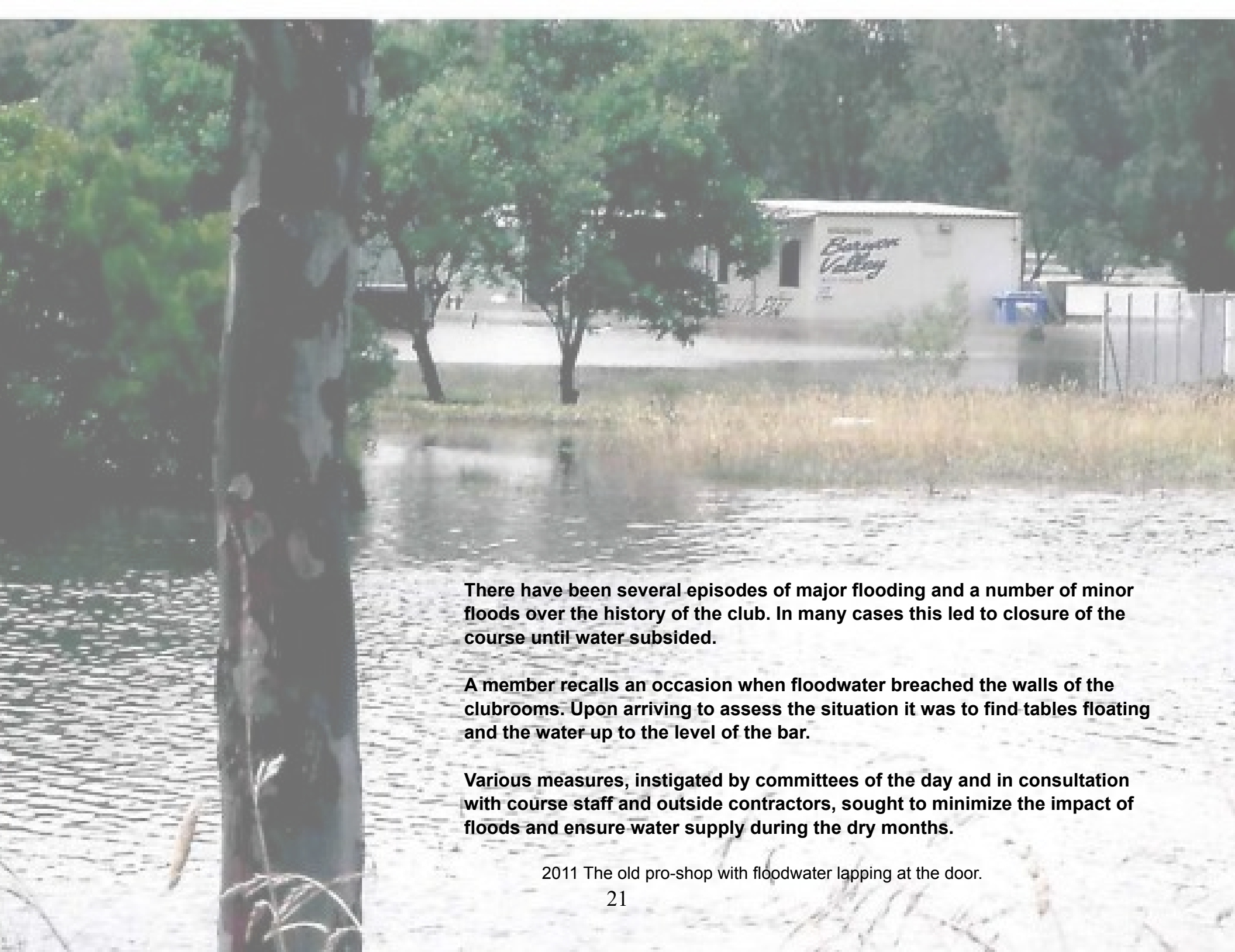

There have been several episodes of major flooding and a number of minor floods over the history of the club. In many cases this led to closure of the course until water subsided.

A member recalls an occasion when floodwater breached the walls of the clubrooms. Upon arriving to assess the situation it was to find tables floating and the water up to the level of the bar.

Various measures, instigated by committees of the day and in consultation with course staff and outside contractors, sought to minimize the impact of floods and ensure water supply during the dry months.

2011 The old pro-shop with floodwater lapping at the door.

Course Development and Major Projects

One of the major factors limiting the development of the course was the poor drainage which, after heavy rain or flooding, left the fairways water logged and muddy, days after the rain stopped.

The Jerringot Wetlands, alongside the club entrance and the 18th fairway, acted as a retarding basin for the storm water runoff from much of the Belmont area. Once its capacity was reached the overflow invaded the golf course.

Brian Robins (Life Member) remembers the extra effort required to push his golf buggy along fairways, slushy with mud (having his small son riding atop his buggy probably didn't make it any easier).

Clinton Dupe, former manager, recalls a roster of volunteers who would collect 2000- 3000 range balls each evening, for days at a time, when it was too muddy for the ball cart to be in use. He also remembers Club President, Barry Wasley, single handedly, digging a trench to help water drain from the storm water overflow that would invade the course after heavy rain.

The floodwater from the Barwon River is heavily saline causing the additional problem of killing grasses and trees when it lays on the course for extended periods. This was another blow, undoing the work of council staff and volunteers to plant hundreds of trees and sow the fairways.

Something needed to be done to address the drainage problem.

Having received the control it most needed the club engaged Consulting Engineers, Fisher Stewart P/L, to carry out a topographical survey of the course. Their charter was to design drainage systems to overcome regular minor flooding and intermittent waterlogged conditions on the course.

Although surface drains were constructed, as recommended, the major feature of the design was the laying of a large diameter underground pipe-drain from the Jerringot Wetlands, at the west of the course, to the Barwon River.

Drainage System

One of the problems was that the drains beyond the boundaries of the course were not well maintained. The build up of silt and growth of reeds in these drains impacted the effectiveness of the drains to adequately disperse excess water from the course.

Instructions to consultants included, not only for an adequate drainage design, but also for the best outcomes for environmental and visual enhancement of the course by way of improved water bodies, capable of longer term retention of water.

In 2002 the club made a submission to the Corangamite Catchment Management Authority. This outlined the recommendations from the consultants and sought support for requests to the City of Greater Geelong for rehabilitation of the major drains through the golf course, Belmont Common and beyond to the Barwon River and Waurn Ponds Creek.



Course Development & Major Projects cont.

During the early stages of this work, astute persons within the club saw the possibility of the major drain being the source of a "free" water supply to reduce the costly reliance on "town water" during dry summers and times of drought. This generated the plan to construct the two large dams now on the course.

The underground drain was intercepted at the east side of the 11th fairway. A pump pit was constructed and pumping equipment installed to lift stormwater into the dams.

These works paved the way for better reticulation and watering decisions throughout the course and contributed to the dramatic improvement to the condition of the course through the yearly seasonal changes.



The 2 dams constructed to store storm water pumped from the councils storm water network for use as irrigation on the course.

The drainage systems and first dam were completed in 2006. The 2nd dam, upgrading of the electrical supply, new pumping station, new town water supply and further drainage works were completed in 2008.

This was a major project with the planning stage commencing in 2001 and completed in 2008 at a cost of \$250,000.

*Project officer Clyde Hunnam, MP Darren Cheesman, Club President Mark Thomas & Manager Robert McFarlane
Photographer: Reg Ryan/Newspix April 2008*



Much has been said about the flooding and drainage problems but times of drought caused a different set of problems. Members recall a roster of volunteers who would water their allocated green either very early in the morning or evenings after work. Some sprinkler systems were installed but hand watering was preferred as it conserved water. Town water had to be purchased at a cost of many thousands of dollars. During hot summers or drought conditions the cracks would open in the fairways and it was very difficult to find a good lie.

Thus the construction of the dams made the club less reliant on the purchase of town water and enabled some fairways to be watered.

This is also very important as work continues to re-sow fairways and keep them watered as they become established.



Course Development & Major Projects cont.

To appreciate the determination and vision of those who instigated these major works we need to consider the number of stakeholders who had to be consulted before any work could proceed.

These included the City of Greater Geelong, the Corangamite Catchment Management Authority, Department of Natural Resources and Environment, Barwon Water, the Geelong Field Naturalists Club, Geelong Environment Group and neighboring user groups.

Also consider the work necessary to fund projects whether that be applying for grants, allocation from the club budget and, at times, seeking funding from members.

Prior to 1996 the council carried out maintenance work at the club, sometimes not to the best of standards.

In 1996, as the club assumed partial management responsibilities, there was a maintenance agreement with the City of Greater Geelong. Two full time council employees were attached to the club for general maintenance duties. The club paid \$160 000 to the council per year as part of the agreement and included course maintenance equipment.

Jim Lane was employed by the council and his diligence and enthusiasm greatly contributed to the development of the course. Unfortunately his skills were required elsewhere and in 1998 he was transferred to Queens Park Golf Course. Despite this Jim maintained his interest in the Barwon Valley Golf Club and a shield event has been named in recognition of his contribution to the club.

From 2000, and after assuming full management and maintenance responsibilities, the club appointed their own Course Superintendent and course staff.

Course Superintendents	2000-2001	Shane Symes
	2002-2013	Luke Primus
	2013- 2014	Matt Shuttleworth
	2014- Current	Colin Foster



The work carried out by course staff should not be oversimplified. While it's readily apparent when fairways and greens are being mown, what should be appreciated is the knowledge, experience and persistent effort that goes into presenting the course. Coring, fertilizing, weed and pest control, soil improvement, sowing of drought and flood hardy grasses, irrigation and drainage, pathways and walk-off areas- the list goes on!

Course Development & Major Projects cont.



Photographer: Phillip Stubbs/Newspix, Feb. 2005

It can be seen from this aerial shot that a number of the greens and tee boxes remained above the waterline.

The work carried out to elevate the greens and tee boxes helped protect them from flood water. However significant flood episodes has caused damage requiring hard work to restore the greens to an acceptable state which came at considerable cost, depending on the extent of damage.



The continuous work to improve drainage around the course.
Drainage work to the left of the 3rd green.



Part of the "fleet" of vehicles used for work on the course. The club has purchased some of the vehicles and has a lease agreement for others. More occasional work may require a contractor and specialized equipment.

In 2014 a water treatment plant was installed in the work compound. This is used to treat the water used when the ground staff clean vehicles and chemical spraying units. The run-off in the washdown area is purified by a completely organic solution of microbes. The treated water finds its way into the wetlands, mitigating environmental impact.





Course Development & Major Projects cont.

Holes 14, 15 and 16 had to be redesigned and refigured in a 1.5 million dollar project when Vicroads realigned the Breakwater Bridge.

The work was necessary because the original 14th hole was too close to the bridge project. The holes were closed for 10 months as the work was undertaken. Players played a composite course during the construction.

The club engaged the services of Bob Shearer to redesign the 3 holes. The redesigned holes all remained par 4 though are more challenging and with undulating greens creating more interest.

The official reopening of holes 14, 15 and 16 was in 2011.

*Photographer: Leanne Churchill/Newspix Nov. 2011
Club President Gerard Squire(left) with Bob Shearer*

The course improvements over the years has been due to the expertise and hard work of the course superintendents and the course staff and volunteers under their direction,

The progressive replanting of fairways with drought resistant Santa Ana couch grass and adding to the irrigation system has resulted in improved playability of the course through hot and dry summers.

Course Development & Major Projects cont.

The course throws up some challenges, particularly the southern section of the course which was an old tip site for the disposal of waste. This ranged from household garbage, industrial waste including old tyres, car bodies, machinery waste, foul smelling waste from fish processing premises and everything in between. Only recently Colin Foster(course super) and his crew encountered largish rocks, concrete and bricks, close to the surface, as they worked alongside the 15th fairway.

Soil sampling by Consulting Engineers Sinclair Knight Mertz, in 1998, indicated the presence of highly toxic substances in those land fill areas.

In 2016 the burn on the 11th hole was created to link the 2 hazards at either side and potentially control the amount of water in either. An added benefit was alleviating the problem of the salt affected area on the right hand side of the footbridge. The position of the burn reduces the time water sits in this area and the ill effects of salt accumulation.

It's amazing to now see the beautiful fairways and greens at the southern end and kudos to all those who worked to establish this part of the course.



The work undertaken to improve the course for golfers has also provided an idyllic haven for wildlife.

The course staff ensure we only plant native plants, which are supplied by the Council. Volunteers carry out most of the plantings and maintenance in the early stages of growth. Course staff also follow current recommendations to ensure that the use of chemicals has minimal environmental impact and, as such, are always looking for the most environmentally friendly solution to any issues that occur.

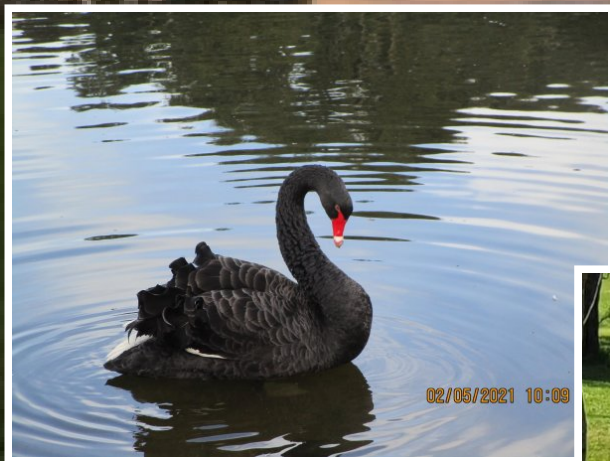
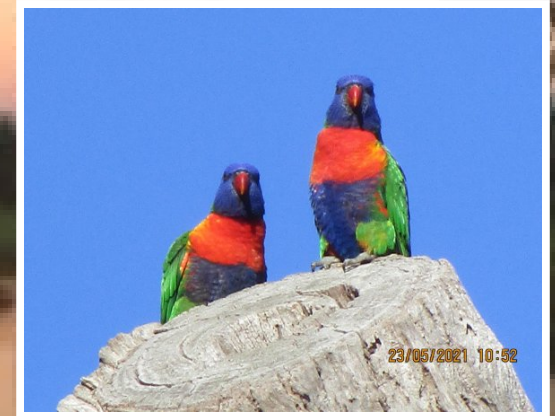

The Driving Range



The driving range was established in 1975 and was initially run by volunteers on a Thursday evening. The word "established" is used loosely as, initially, it was little more than an open area to hit balls, complete with dips and bumps. After heavy rain it was often muddy and balls would become embedded and require a team of helpers to retrieve the balls from their muddy resting place.



Work has been carried out over the years to level the range, improve drainage, extend fencing, provide shelter for golfers, the addition of a coaching area, chipping green and bunker. The fencing was extended in 2013, new range mats and targets were put in place in 2020 and further drainage works in 2021.

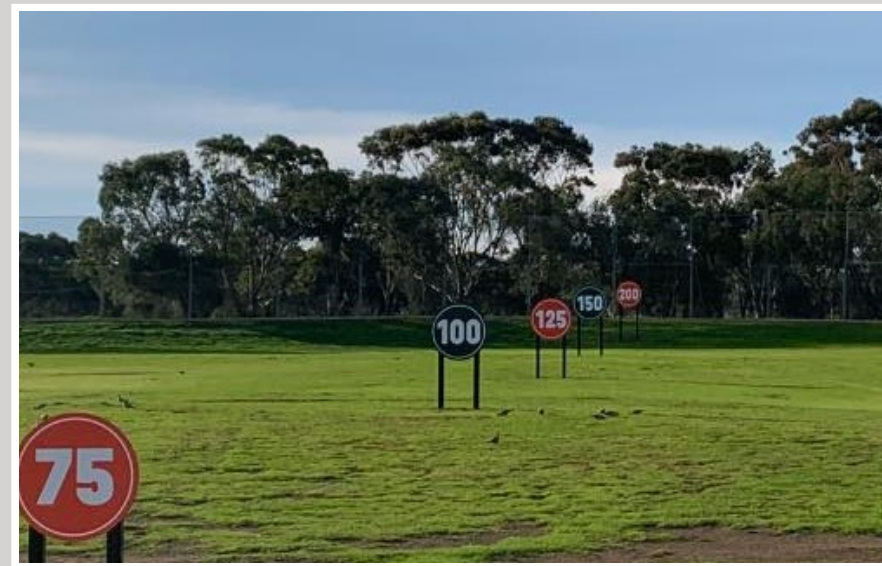

The Volunteer Workforce

Our club has a strong culture of volunteering which continues to this day. There are the committee members who have guided the club through some turbulent times and ensured the operation of golf competitions and events. Also the volunteer workforce which has had a dramatic cost saving effect on the club's operations, the enhancement of the course, the buildings and infrastructure.

Robert Trickey

A number of people volunteered in several areas over many years. Robert (Bob) Trickey (Life Member) epitomizes such volunteers.

Bob joined the Barwon Valley Golf Club in 1981. He was Vice-Captain in 1985 and 1986, Captain 1987 to 1989, Handicapper from 1990 to 1992 and President from 1994 to 1996.

Upon retiring from Alcoa in 2009 Bob became an almost permanent fixture on the clubs volunteer workforce, using his work experience to undertake many tasks, be it driving heavy trucks, tractors, mowers and earth moving equipment, felling damaged trees with the chainsaw or pick and shovel work.

Bob instigated the construction of the original putting green out the front of the clubhouse, now replaced with a synthetic green. This became the centre for some hotly contested putting competitions after the 9 hole chicken run on a Friday evening!

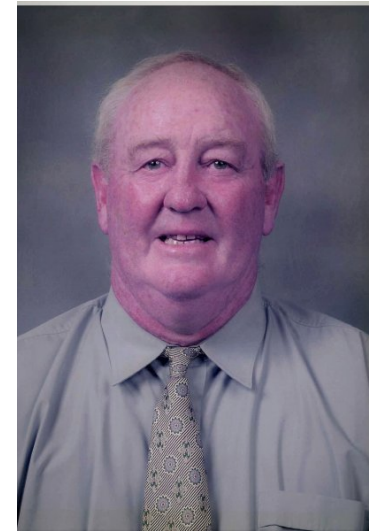

Bob captained a number of pennant teams which were successful in the Geelong and District Golf Association. His great satisfaction came from the management, coaching and guidance of junior pennant teams.

In speaking to Bob about the club, it's apparent how important the connection with the club has been in his life.

After some work out on the course, the volunteers have morning tea with Harry's famous toasties!



Volunteers cont.

Brian Robins



One of the most demanding roles as a volunteer was that of club captain. In the early days, before the advent of any automated system, competitions and handicaps were done manually by the captain and handicapper. This involved many hours of work with each card having to be checked, results entered and handicaps adjusted if necessary.

Life Member, Brian Robins, undertook these roles over a number of years. Brian joined Barwon Valley Golf Club in 1986, and in 1992 he was elected to the General Committee. He was appointed Captain in 1993 and remained in the role until 1997. In 2002 Brian was reappointed to the position of Captain for an additional term of 4 years.

From 2000 to 2001 Brian was the club Handicapper and, due to his computer skills, was instrumental in setting up 'Golf Link' for the club. Golf Link was the automated handicap system which was introduced by Golf Australia in 1999 and which calculates all official Australian handicaps.

Another of our Life Members who took on the role of Captain was Ian Knell. Ian first served as Vice Captain for 3 years then Captain for 10 years, retiring from the role at the end of 2018.

Ian recalls the early starts of a Saturday, opening the clubrooms, playing his round and then staying to check cards, determine the prizes for each grade and collating results. He'd then come in on Sunday morning to do the cleaning ready for the week ahead!

Ian was known to some as "Captain Red Pen" a moniker dubbed due to the red stroke through the scorecard for those whose card was incorrect or unsigned. Disqualification was the penalty for those unfortunate enough to commit such infringements. Ian says the reason he put in so much time was because he loved the club and wanted to make it a good place for members.

Ian Knell



Volunteers cont.

Another person who epitomizes the volunteer spirit is Life Member, Brenda Carmody. Brenda joined the Club in 1992. From 2006 she was an active committee member taking on roles as Club Secretary, Ladies Captain for 8 years, Ladies Secretary and delegate for the SWDGLA and SWGA.

As Lady Captain Brenda was responsible for organizing major events such as the Annual Challenge Bowl, Amenities Days and the Ladies Open Tournaments. Up until recent years cards were hand written sometimes entries exceeded 100 players.

During her 27 years at the club, Brenda has volunteered in the kitchen, the Bar and was involved in fundraising and social events.

Brenda's dulcet tones can often be heard from one side of the course to the other. Confine that voice to the four walls of the clubroom and she had everyone's attention! Also, no one can quite ring the bell in the clubrooms with the same rigour as Brenda when readying to announce the results of the day!

Many members' volunteer role was in serving on the Committee. In particular, the position of club secretary required dedication and commitment.

John Davies (Life Member) joined the club in 2004. John served two years on General Committee and twelve years as Club Secretary. John has been described as "the glue that held the club together." This was during a time when the club was struggling financially, membership was down and the costs of course maintenance and improvements were increasingly hard to meet.

The continuity of John's service was important in ensuring that the knowledge of the club's processes and procedures was preserved for incoming committees. John continued in this role until March 2019 when he resigned due to ill health and passed away in May that same year.

Brenda Carmody



John Davies

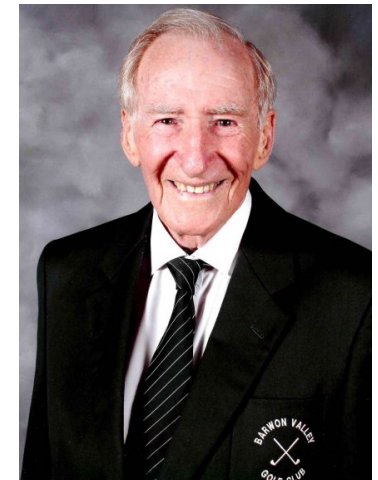

Volunteers - Social and Fundraising

An important part of being a member of a club is the opportunity it provides for developing friendships and social connections.

In those early years members put in an inordinate amount of work to help establish the golf course and club. However the recollections of these times, for some of our senior members, also include a warm sense of camaraderie and friendship.

The club became the centre of social activity and the friendships extended to golf trips away, outings to Moonee Valley trots, barbeques and picnic days, bingo, trivia and card nights. Events were celebrated with dinner and dancing. There was often a dual purpose of raising funds for improvements to the clubhouse.

Janet Oman (Life Member) was at the forefront of social and fundraising events along with Joan Nolan, Brenda Hurst and others.

Janet was on the House and Social Club Sub- Committee, amongst other committee roles, and she recalls the fun generated by holding these events. She says she enjoyed every minute of it and described the close relationships formed with other club members as a type of family.



Janet Oman

Janet Oman (Life Member) joined Belmont Golf Club in 1985 and very quickly became an active member on both the Ladies and General Club Committees over the years. Ladies Secretary, Ladies Treasurer, Ladies Assistant Handicapper and Handicapper

Committee and other work aside, Janet has been a very successful player and a major contributor to women's Pennant and regional events.



Volunteers Social & Fundraising



Kevin Hussey

These events, when held at the club, were often catered for by volunteers. An impressive workforce would man the bar and kitchen to provide food and drink for events and also for weekly competitions.

Kevin Hussey (Life Member) was one of those volunteers who put in many hours behind the bar. He recalls opening up the clubrooms on a Saturday morning about 6 30am. He'd get things in order for the day before going out to play his round. He was at the ready for when golfers came in, ready for some refreshments, and stayed until the last golfers left around 6 at night! The next morning he'd be there with Ian Knell to do a clean up!

Kevin joined Barwon Valley Golf Club in December 1990. Kevin served on the General Committee over two periods for a total of 12 years as well as volunteering as Bar Manager. Even though it was often long hours he fondly remembers the chance to laugh and joke with other members.

This culture of volunteering continues to this day with a steady team of volunteers supporting the work of the course staff with mowing, gardening, watering young trees, emptying bins, filling tee divots, painting and other general maintenance tasks.

We also have members who volunteer on club committees and many other members who readily assist when help is needed for specific events.

The shift to employ paid staff for course work, club management and clubhouse staffing means less reliance on volunteers however the contribution of members will always be valued.

Other Challenges

Fraud

After the change in management in 2018, it was discovered that a significant amount of money had been systematically diverted from club accounts over a number of years. For a club that relied on the hard work of volunteers and generally ran on a shoestring it was a huge blow to realise that the club could have been in a much better financial position. As of 2021 the fraud was still an open investigation though not actively being pursued by the police. An insurance payout of \$106,000, in 2019, partly compensated for the financial loss.



Some of the ladies were a bit excited to get back to golf after lockdown 6 or maybe 7!

Covid Pandemic

The worldwide pandemic of 2019 first made its presence felt in Australia in 2020 and continued into 2021 and 2022. There was a mixed impact on the playing of golf. To reduce the likelihood of disease transmission a number of recommendations came from Golf Australia and restrictions placed on clubs by the State Government. This included; playing golf wearing masks, no shaking hands, flagstick to remain in, no use of bunker rakes, the clubrooms closed for months, playing in pairs, no sharing of carts, no competition for a time, the introduction of electronic scoring with the Miscore app and then having to show proof of double vaccination to play! The course closed totally for 6 weeks in 2020 and closed on and off in 2021.

Financially the club weathered the pandemic well with a boost in membership. Golf was one of the few activities that resumed in some form in the early months. This caused a different problem with members having to adapt and organize early to get a booking at peak times.

Governance - One Club

In 2018 Golf Australia's launched a strategy "Vision 2025" which aimed to increase women and girls participation in golf. This was followed in 2019 with Guidelines from The Human Rights Commission, in partnership with Golf Australia, to provide practical guidance on discrimination legislation and how golf clubs can promote equal opportunity for women and girls.

Both of these documents encouraged clubs to look at their policies and procedures to ensure they meet their legal obligations and were gender inclusive. To address these matters, the committee of the time, instituted some changes.

After several attempts to find a governance structure that would represent the interests of all members, changes to our club's constitution in 2019 and 2020 embedded a structure to ensure a more equal representation of both male and female members on the Committee of Management. This was also reflected in the restructure of the Match Committee. Men's and Women's events were to be conducted under the one set of standards and conditions of play.

In 2020 the Ladies Committee discontinued operating as a separate entity within the club. The organization of Women's' golf came under the umbrella of the Match Committee.

Honour Boards & Shield Events

Mens' Events

JOHN MCDONALD SHIELD – MEDAL OF MEDALLIST (1974)

In 1972 John McDonald was elected to the inaugural Belmont Golf Club Committee as Advisor. John donated a shield, to be awarded to the men's Medal of Medallist.

We believe that John was another long serving volunteer, responsible for helping set up the Belmont Golf Club (former name of the Barwon Valley Golf Club).

JOHN DAVIE VOLUNTEER 9 HOLE STABLEFORD (2019)

Life Member (refer p37) This special event for club volunteers was set up in 2019, with golf & dinner for the volunteers and their partners.

GORDON RUSSELL MEMORIAL Board event & Shield (1975)

4BBB Stableford (Tuesday event) 1975 - Gordon was the inaugural President of the Belmont Golf Club (1972-73)

In 1975 the Club recognized Gordon's contribution by setting up an event, the Gordon Russell 4BBB Stableford event, to be played on Tuesdays. His family funded a board in 2008.

Gordon passed away in 1994 aged 75.

ERIC LYONS SHIELD 72 hole Stroke Nett (1973)

Eric was the President of the Shire of South Barwon in 1972 when a meeting was held to form a golf club Committee.

Eric facilitated the relocation of a dwelling to be used as the first clubrooms and supported the club in many ways. To show their appreciation the BVGC established this Shield event, to be awarded to the winner of the 72 hole Nett in the Championships.

W PERRETT SHIELD Stableford 4BBB (1973)

Bill Perrett was a founding member of the Belmont Golf Club. He was appointed as the first Publicity Officer and elected President from 1974 – 1981

(Refer p10)

Honour Boards & Shield Events - Men's Events cont.

GRAEME BATH SHIELD – 54 HOLES STABLEFORD (1982)

Graeme was the Belmont Golf Club Captain, for a total of 6 years from 1973 to 1975 and then again 1977 – 1979. Graeme along with Bill Perrett, Neil Huggins and the committee of the day, spent many hours lobbying, for the club's inclusion into the Geelong District Golf Association. He also spent countless hours in negotiations, with the Shire of South Barwon and others, to extend the course to 18 holes, which came to fruition in 1978.

ALLAN HUBBARD SHIELD- 54 HOLE PAR. (1973)

This event was set up by the Belmont Golf Club to honour the contribution of Allan Hubbard to the formation and management of the Club over a long period of time. This 54 hole shield event is run over 3 consecutive Saturdays. Allan also ran the Club Office for the Shire of South Barwon, prior to the Belmont Golf Club being formed. He continued to in that position until 1995, along with the help of other Club volunteers.

JOHN LONG AND LEON MCNAMARA SHIELD (Life Members)- (1999)

Foursomes Championships. John Long and Leon McNamara were integral players in to the fight to save the club when the area of the Belmont Common was threatened by a proposed water sports complex. (refer p17 & 18)

ROY CLARKE MEMORIAL TROPHY - Lefties v Righties (2005)

Roy was one of a number of the club's long term volunteers, whose dedication gave this Club the basis, on which we thrive today. His family sponsored this trophy, in acknowledgement of his volunteer work around the course.

ROB TRICKEY EVENT (Life Member) Stableford -(2019)

An Open stableford event, between Barwon Valley GC v Lorne GC, is held over 2 consecutive weekends. One of the rounds being played at the Barwon Valley Golf Club on a Saturday and the second round at the Lorne Golf Club on a Sunday. Each year the rounds are played in the reverse order. This was an acknowledgement of the service of Robert Trickey to both these Clubs. (refer p34)



Honour Board & Shield Events

Women's Events

NEIL HUGGINS PERPETUAL TROPHY- Life Member

Ladies Club Champion. (1977)

Neil Huggins was one of the founding members Belmont Golf Club (refer p 11)

E J PRICE PERPETUAL TROPHY – Ladies Medal of Medallist. (1978)

This trophy was set up by Edward (Ted Price) and dedicated to his wife Dorothy who was the inaugural Lady President of the newly formed Belmont Golf Club and also the first winner of the trophy. She held the position of Lady President for 4 years, 2 years as Lady Treasurer, 2 years as Lady Captain and club Vice Captain for several years. Dorothy (Dot) was the Ladies' Club Champion in 1978,79 & 80 and Medal of Medallist in 1978 & 1979.

LADIES 4 BALL CHAMPIONSHIP (2002) Board Event

In 2002 the Ladies' committee suggested that the Club set up this event, as an alternative Championship, to cater for those unable to play in the mid-week Championships.

LADIES A & B CHAMPIONSHIP TROPHIES (1991)

In 1991, as the Club membership grew, GIO Insurance Co, donated 2 Perpetual Cups to be awarded to the A & B Grade Champions. These trophies are currently still in use. (2021)

LADIES C GRADE CHAMPION TROPHY -2019

In 2018 Ann Lynch became aware that the Ladies' C Grade Champion, did not have a perpetual trophy. This was the only Championship event without a perpetual trophy.

Ann and her husband Michael, kindly donated a perpetual trophy, to be awarded to the C Grade Champion from 2019 onwards.

Honour Boards & Shield Events - Women's Events cont.

B RUSSELL 36 HOLE HANDICAP Perpetual Trophy (1977)

Betty was the inaugural Lady Captain, holding that position for 3 years, from 1972-74.

This trophy was provided to the Ladies by the Russell family to use as they saw fit. This trophy has been awarded for many years to the Ladies' C Grade Champion. In 2019 the trophy was awarded to the C Grade Nett Champion.

JOAN NOLAN OVERALL NETT ECLECTIC TROPHY (2012)

Joan Nolan (Life Member) joined the Belmont Golf Club in 1985 and was a very well respected, hardworking member of the Club volunteering in a variety of roles throughout her time at the club. (refer p 13)

LADIES' 9 HOLE NETT ELECTIC TROPHY (2019)

In late 2018 a 9 hole competition was set up for the ladies who were regularly playing 9 hole social golf on Wednesdays. The 9 hole competition was set up to keep those members, who were unable to play 18 holes, as active and valued members of the Club.

In 2019, Jan Jewell, the Lady Captain at the time, donated a Perpetual Trophy to be awarded annually, to the winner of the 9 holes Eclectic.

BETTY RUSSELL MEMORIAL - HMPSKO Perpetual Trophy (1979)

In August 1978 Betty passed away and her husband Gordon set up a Perpetual trophy, in her honour. The trophy was awarded for the Ladies' Handicap, Match Play, Singles Knockout champion.

This event has not run since 2015, but the ladies are hoping to try to revive it in a different format.

JANET OMAN PERPETUAL TROPHY (2017)

In 2016 the BVGC awarded Janet Oman Life Membership for her dedicated service to the Club over many years.(Refer p p38)

In 2017, Janet approached the Ladies Committee, offering to sponsor an event, and asking for it to be included in the Fixture. This was to take the format of the best 3 out of 4 rounds of Stableford.

Honour Boards & Shield Events cont.

Mixed Events

Mixed Events are great social events for the club, adding to the sense of community and providing opportunities for new friendships.

TAB AND DORIS ADAMS 4BBB MIXED STABLEFORD (Shield). (1991)

Tab Adams was a builder and was very involved in the establishment of the current Clubhouse, which was the old Belmont Library and moved here in the mid 70's. The Library did not have any toilet facilities, so under Tab's guidance, the refurbishment and toilet extension were undertaken. Tab was also instrumental in getting the associated septic system in place. Tab was ably supported by his wife Doris Adams, whilst undertaking these tasks.

JIM LANE MIXED PINEHURST – (Shield) (1995)

Jim was the Green keeper for the Shire of South Barwon, when the Belmont Golf Club Course was run by the Shire 1972 - 1999. When the water sports complex was being considered the council no longer provided the upkeep of the course, which became very neglected. Jim continued to maintain the course with very limited resources.

PAUL CAMPBELL MIXED STABLEFORD TROPHY (2009)

Paul Campbell was a close friend of Jim Lane and helped Jim with the mowing and upkeep of the course in the 1980's and early 90's, even though he was not a golfer. Paul went on to join the club and continued to volunteer, assisting with maintaining and developing the course. He was a former President of the Club, holding that position for 3 years from 2003-2005 and served at least 5 years on the General Committee.

JOAN NOLAN MEMORIAL MIXED PINEHURST.

(Life Member) Board Event. (2014) (refer p 13)

District Pennant- Significant Wins for the Club

Many members have proudly represented the club in district pennant competitions. Some teams achieved success and brought the flag home to the club !!!

Year	Division	Team Members
1983	SWDLGA Women's Leigh Pennant	B Coleman (Captain), I Power, B Thomas, B Icke, M Huggins, M Jennings, H Spiller, M Perrett.
1984	SWDLGA Women's Leigh Pennant	B Coleman (Captain), I Power, B Thomas, S Hickman, M Regan, H Spiller, M Perrett, M Sutclif
1986	SWDLGA Women's Leigh Pennant	S Hickman, M Cole, B Coleman, H Spiller, J Sceney, I Power, D Stevenson, G Lauder
1986	GDGA Men's Division 5	R Trickey (Captain), H Adams, C Dwyer, P Creatie, C Tingate, D Watson, M Zentgraf
1986	GDGA Junior Divi 2, Trevenen Shield	B Creaty (Captain), C Tingate, A Wills, F Murray, B Murray
1987	SWDLGA Women's Leigh Pennant	N Milne (Captain), J Parker, C Dickson, M Higginbothom, B Hurst, M Galbraith, J Wood
1989	SWDLGA Women's Otway Pennant	L Brady, J Baxter, J Nolan, M Stewart, P Williams, B Icke, S Hickman, N Milne, R Barklay, M Cole
1990	SWDLGA Women's Division 6	N Milne (Captain), K Robbins, J Howard, L Brady, B Thomas, Joan Nolan, Janet Oman
1991	SWDLGA Women's Division 5	L Brady (Captain), J Nolan, H Douch, M Fitzpatrick, J Howard, B Thomas, K Robbins
1994	SWDLGA Women's Division 4	Karen Robins (Captain), Judy Baxter, Janet Oman, B Johnson, Joan Nolan, L Carey, B Thomas
1994	GDGA Junior Div 2 Trevenen Shield	M Duncan, D Jacques, Jeff Crabbe, K Henderson, S Matheson, A Matheson
1996	SWDLGA Women's Division 8	F Long (Captain), J Baxter, M Cole, L Russeler, M Fitzpatrick, J Nolan

District Pennant- Significant Wins for the Club

Year	Division	Team Members
1996	SWDLGA Women's Leigh Pennant	B Hurst (Captain), J Parker, J Wood, N Milne, M Galbraith, J Hunt, C Dickson
1998	GDGA Men Division 2 Reserve	J Arnold, S Matheson, A Matheson, S Chapman, D Gloster, B Robins, I Henderson, G Arnold
2001	GDGA Junior Div 1 Westerveld Shield & Ford Cup	J Arnold (Captain), C Bromley, I Nichols, M Robins, Dean Cook, Danny Cook
2001	SWDLGA Women's Division 4	K Robins (Captain), J Oman, J Baxter, F Long, M Fitzpatrick
2003	GDGA Men's Division 3	K Henderson, C Perrett, M Scoble, B Costa, E Sormaz, D Cook, D Jacques,
2003	SWDLGA Women's Leigh Pennant	F Long, J Tuohill, N Milne, B Hurst, P Bowler, M Cole, M Galbraith
2006	SWDLGA Women's Division 4	Judy Baxter (Captain), K Robins, N Stacey, K Walker, B Bogacki, M Fitzpatrick
2009	GDGA Men's Division 3	M Scoble (Captain), D Jaques, J Bromley, B Costa, D Ellis
2012	GDGA Men's Division 3	A Korth (Captain), W McCaskill, K McFarlane, S Rayland, I Knell, M Scoble, H Bowen
2014	GVGDA Veterans	R Ellis (Captain), I Knell, G Arnold, D Kelly, R McFarlane
2015	GDGA Men's Division 3	H Bowen (Captain), W McCaskill, C Crabbe, A Korth, N Clarke, P Thompson, M Kennedy, D Foster
2017	SWGGA Women's Division 3	J Penny (Captain), N Stacey, A Lynch, S Holmes, B Bogacki, J Baxter
2018	SWGGA Junior Div 2 Trevenen Shield	R Monteith, M Fitzgerald, L Kors, L Snart, B Nichols, M Crabbe
2021	SWGGA Men's Division 1	M Kennedy (Captain), M Crabbe, Jeff Crabbe, J McDougall, R Moreland, D Foster, P Thompson, S Trickey, K Henderson
2022	SWGGA Women's Sunday Pennant	B Van Der Heide (Captain), M Massey, L Jennings, M Almond, K Flynn, M Jones
2022	SWGGA Men's Division 1	M Kennedy (Captain), S Trickey, M Crabbe, D Foster, P Thompson, R Moreland, M Spalding, J Crabbe, R Parker, M Beasley, T Cameron

The Big Win!

All pennant competition requires teams to perform consistently, under pressure and against teams of comparable skill. The pinnacle of district golf is to reach finals and have a win in Division 1. This happened in 2021 and a special accolade goes to the Men's Division 1 team for their win against East Geelong Golf Club.

The win was witnessed by an enthusiastic group of Barwon Valley members!



The Div 1 Pennant drought was well and truly broken with another win in 2022!!

Back: Joel McDougall, Mitchell Crabbe, David Foster, Matt Kennedy (c), Simon Trickey
Front: Peter Thompson, Ross Moreland, Jeff Crabbe, Kevin Henderson.

Significant Wins

The club has also been successfully represented in other district and state competitions.

Year	Event	Name(s)
1987	GDGA Junior Champion	David Board
1989	GDGA Junior Champion	Craig Tingate
1989	GDGA Men's Champion	Craig Tingate
1990	June Gulliver Perpetual Trophy	Margaret Fitzpatrick
1995	Advertiser Shield (discontinued)	R Sheriff, R Dowe, M McLean
1999	Rene Austin Memorial Shield	Margaret Cole
2000	Advertiser Shield (discontinued)	Brad Costa, D O'Leary, Barry Costa
2004	Rene Austin Memorial Shield	Karina Walker
2005	Dorothy Smith Veterans	Jenny Clayton
2009	VVGA Veterans State Champion	Ross McFarlane also 2012-2013, 2015-2018
2010	Dorothy Smith Veterans	Jenny Clayton
2011	GDGA Junior Champion	David Foster
2011	Joy Burton Salver	Di Adams, Melinda Almond
2011	Silver Salver Foursomes	Janet Oman, Dawn Forbes
2015	GDGA Men's Order of Merit	Jeff Crabbe
2017	SWGA Boys Order of Merit	Mitchell Crabbe
2018	SWGA Junior Champion	Mitchell Crabbe
2021	VVGA Veterans State Champion	Peter Thompson
2021	SWGA Dorothy Smith Veterans	Janet Barras

**Just a few of those
winning smiles!**



2011 Janet Oman & Dawn Forbes
Silver Salver Foursomes



2011 Di Adams and Melinda Almond
Joy Burton Salver



2021 Peter Thompson,
Veterans State Champion



Ann Lynch & Nathan Sharrock
Jim Lane Mixed Event



Fourball Winners



Beac Shield



2001 Junior Ford Cup

The Next Chapter

With the clubroom refurbishment underway, a burgeoning membership and good governance and management structures in place, the club looks forward to continued growth and development.

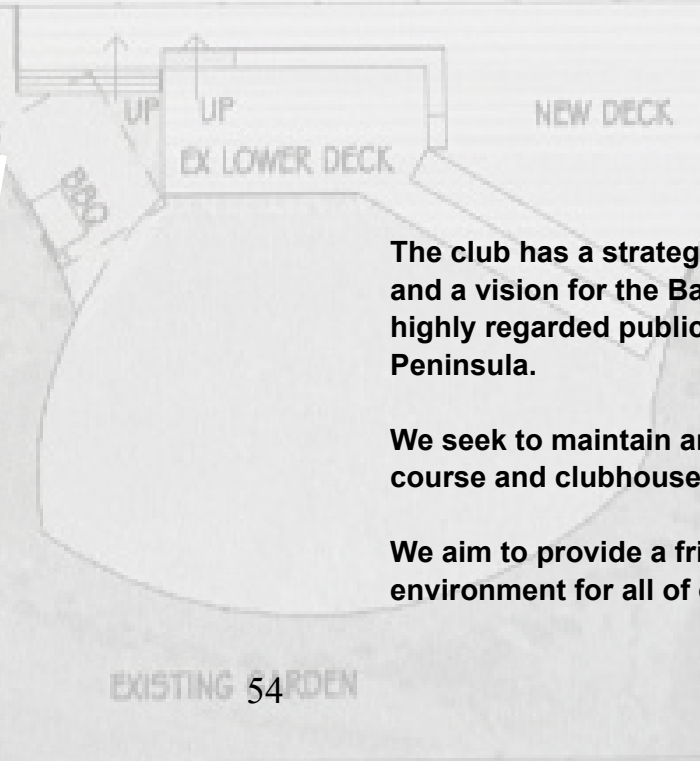
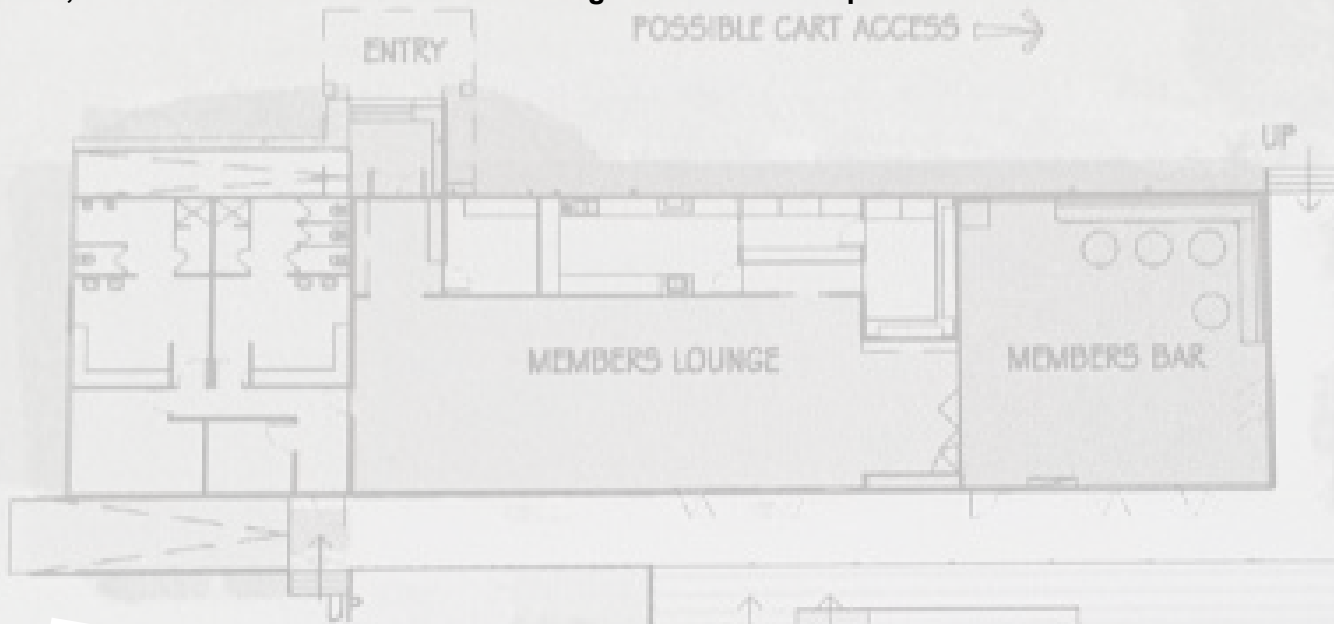

The club has a strategic plan to see us into the future and a vision for the Barwon Valley Golf Club to be a highly regarded public Golf Club on the Bellarine Peninsula.

We seek to maintain and continuously improve the golf course and clubhouse facilities for members and guests.

We aim to provide a friendly, caring, and respectful environment for all of our members, visitors, and staff.

Make your slice of history!

Barwon Valley Golf Club: 50 Years

Copyright © 2022 by BVGC

Compiled by Helen Mays

Acknowledgment

Multiple people have contributed to this book through personal recollections, previously compiled records of the club's history and documentation of significant events. Thanks to Jan Jewell for her research into the origins of Honour Board and Trophy events.

All rights reserved. No part of this book may be reproduced in any form or by any electronic or mechanical means including storage and retrieval systems without permission in writing from BVGC

Powered By Bookemon. www.bookemon.com



Barwon Valley Golf Club acknowledges the Waddawurrung people, the Traditional Owners of the land upon which our golf course is located. We pay our respects to the Elders past, present and emerging and acknowledge their spiritual connection to Country.